

# Arthrex Double Compression Plates

*Four styles of stainless steel plates in three sizes each. Providing stability and compression for many types of surgical procedures*

Lapidus Arthrodesis

- Stainless steel design with 20 mm, 25 mm and 30 mm lengths
- Shorter inner arms to increase strength while obtaining more compression with oblong compression slot
- Smaller footprint after distraction than comparable plates
- Load-sharing plates for bony fusions

1st MTP Arthrodesis

Talonavicular Arthrodesis

Calcaneocuboid Arthrodesis

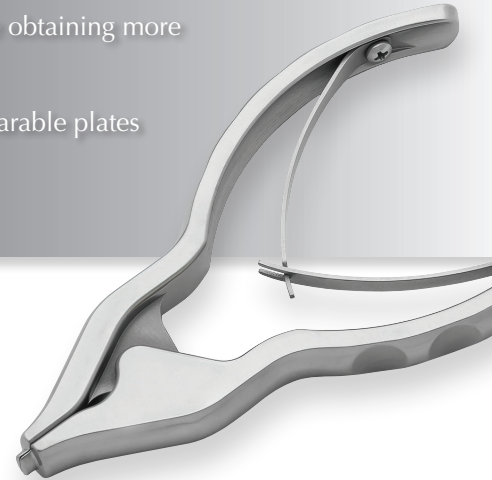

Compression Distractor



Utilizing the oblong compression hole, 14 pounds of compression is achieved\*



The distraction of the inner arms, combined with utilizing a screw in the oblong screw slot, adds 7 pounds of additional compression\*



\*data on file

# Double Compression Plates and the Compression Distractor

Steps taken from our Surgical Technique guide illustrate the ease-of-use and compression aspects that make our plate adapt to patients' needs.

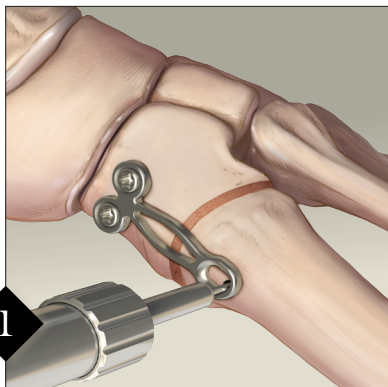

A standard depth gauge is utilized to obtain appropriate length for a 3.5 mm Cortical Screw (or 4 mm Cancellous Screw).

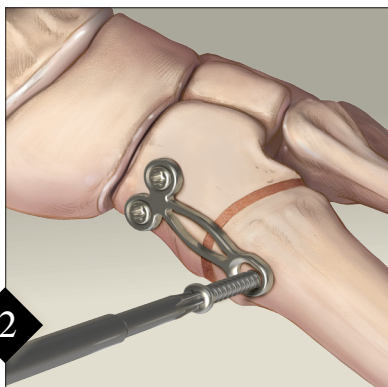

A screw is placed within this hole resulting in the first stage of the compression through the construct.

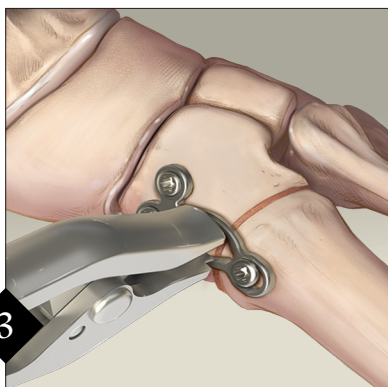

The plate "compressor" is now placed within the plate "arms" and the plate is further compressed to provide the second stage of compression across the arthrodesis site.

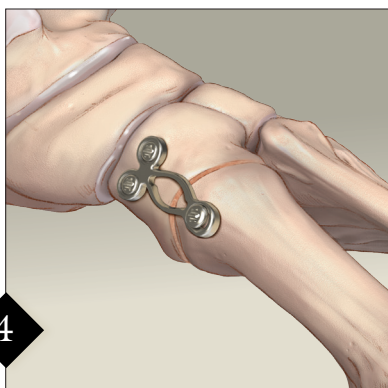

Final construct is demonstrated. *Note: An interfragmentary compression screw can also be placed crossing the joint before or after the plate is secured.*

## Ordering Information

### Double Compression Plate Set (AR-8006S) includes:

Compression Distractor	AR-8005D
Drive Shaft, T15 Hexalobe	AR-8941DH
Driver Handle, cannulated, w/AO Connection	AR-13221AOC
BB-Tak	AR-13226
Drill Guide, 2.5 mm/3.5 mm	AR-8943-14
Depth Guide	AR-8943-15
Drill Bit, graduated, long, 2.5 mm	AR-8943-42
Drill Guide, locking, headed, 3.5 mm	AR-8943-43
Double Compression Plate Case	AR-8006C

### Plates:

Double Compression Plate, 2-hole, 20 mm	AR-8006-20
Double Compression Plate, 2-hole, 25 mm	AR-8006-25
Double Compression Plate, 2-hole, 30 mm	AR-8006-30
Double Compression Plate, 3-hole, 20 mm	AR-8007-20
Double Compression Plate, 3-hole, 25 mm	AR-8007-25
Double Compression Plate, 3-hole, 30 mm	AR-8007-30
Double Compression Plate, 4-hole, Straight, 20 mm	AR-8008-20
Double Compression Plate, 4-hole, Straight, 25 mm	AR-8008-25
Double Compression Plate, 4-hole, Straight, 30 mm	AR-8008-30
Double Compression Plate 4-hole, Square, 20 mm	AR-8009-20
Double Compression Plate 4-hole, Square, 25 mm	AR-8009-25
Double Compression Plate 4-hole, Square, 30 mm	AR-8009-30

### Implants (necessary for procedure, not included in set):\*

Cortical Screws, nonlocking	
3.5 mm x 10 – 60 mm	AR-8835-10 – 60
Sizes: 10, 12, 14, 16, 18, 20, 22, 24, 26, 28, 30, 32*, 34*, 35, 36*, 38*, 40, 42*, 44*, 45, 46*, 48*, 50, 55, 60 mm	
Locking Screws	
3.5 mm x 10 – 50 mm	AR-8835L-10 – 50
Sizes: 10, 12, 14, 16, 18, 20, 22*, 24*, 26*, 28*, 30*, 32*, 34*, 36*, 38*, 40*, 42*, 44*, 45*, 46*, 48*, 50* mm	
Cancellous Screws, nonlocking	
4 mm x 10 – 60 mm	AR-8840-10 – 60
Sizes: 10, 12, 14, 16, 18, 20, 22, 24, 26*, 28*, 30*, 32*, 34*, 36*, 38*, 40*, 42*, 44*, 45*, 46*, 48*, 50*, 55*, 60* mm	

\*all implants are housed in the Ankle Fracture Screw Case, AR-8943C-11

### Optional:

Ankle Fracture Screw Case (auxiliary)	AR-8943C-31
Mini Joint Distractor	AR-8950JD



**Arthrex**

All rights reserved. Arthrex Inc. LS1-0482-EN\_A

Note: The above steps (1 – 4) reflect steps 5 – 8 in the Surgical Technique Guide, LT1-0482-EN.